

EXAM QUESTIONS — Use the questions to test your progress. Check your answers on pages 94–95.

1. A plastic link is to be injection-moulded in a batch of 5000.

Complete the diagram showing the main stages of injection moulding. (4 marks)

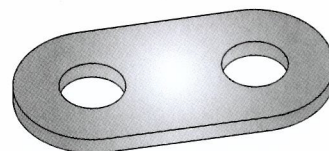

.....

2. A securing bracket is to be made from sheet metal.

a) State a metal that could be used. (1 mark)

.....

b) State an advantage of pressing the metal out of the sheet rather than using other processes. (1 mark)

.....

3. For what purpose would you use a (i) bevel-edged chisel (ii) jack plane (iii) spoke-shave? (3 marks)

.....

4. A 45 mm hole is to be drilled in a piece of plastics sheet.

a) Name a tool that could be used. (1 mark)

.....

b) Explain why a pilot hole would be drilled before using the tool. (1 mark)

.....

5. Before drilling a piece of steel a risk assessment should be carried out. Give two precautions you would take before drilling. (2 marks)

.....

6. Knock-down (KD) fittings are to be used to fit together a shelving unit. The fittings are to be compression moulded.

a) Explain why they are called knock-down fittings. (1 mark)

.....

b) Give two reasons why the manufacturer has chosen compression moulding rather than machining from a solid block. (2 marks)

.....
